

**Windows from wood and aluminium.
Specifications**

25097-2002

32

91.060.50; 53 6130

1. " and transport", "Finnish association of construction product industries" " -1", "VTT building

2. () 24 2002 .

3. 25097-82, 27936-88.
4. 1 2003 .
2 2002 . N 118.

1.

(- ,)

23166

2.

9.031-74.

9.032-74.

9.301-86.
9.303-84.

9.308-85.

9.401-91.

111-2001.
166-89.
427-75.
538-2001.
2140-81.
2695-83.
7016-82.
7502-98.
8486-86.
9416-83.
15140-78.
15612-85.

15613.1-84.

15613.4-78.

16588-91.
17005-82.
22233-2001.

23166-99.
24033-80.
24404-80.

24866-99.
26433.0-85.

26433.1-89.

26602.1-99.
26602.2-99.
26602.3-99.
26602.4-99.
26602.5-2001.
30733-2000.
30777-2001.

30778-2001.

30971-2002.

30972-2002.

3.

23166

4.

4.1.

23166,

4.1.1.

:
() ;
() ;
() .
" " " " , - ,

4.1.2. () :
() :
;
;
;
;
;
() .

4.2. 23166 :

X X X X-X-X (X) X

:

-
-

(4.1.1):

,
,
,

23166

() ,

<*>

<*>

2 1760-1650-130 4 1 + (4 1-16 r- 4) 25097-2002 -

1760 , 4 1650 MI 111, :) 130 , 4 MI 111;
16

30733.
2 2175-720-82 25097-2002 -

() , 2175 , 720 , () 82 .
() ()

5.

5.1.
5.1.1. , 23166

5.1.2.
()
5.1.3.

(-)

(, , ,).

(

5.1.4.

- 1200 , 1800 ;
- 900 , 2300 .
- 80 () .

60 ,

()

(,

).

5.1.5.

- ()
30778, (,) ,

5.1.6.

5.1.7.

() ()

22233.

5.1.8.

a

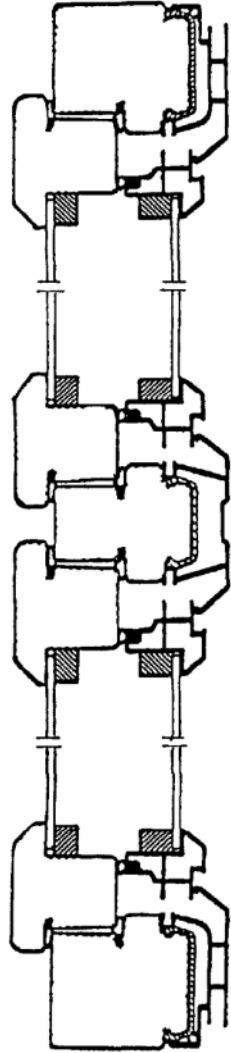

1.

2.

б

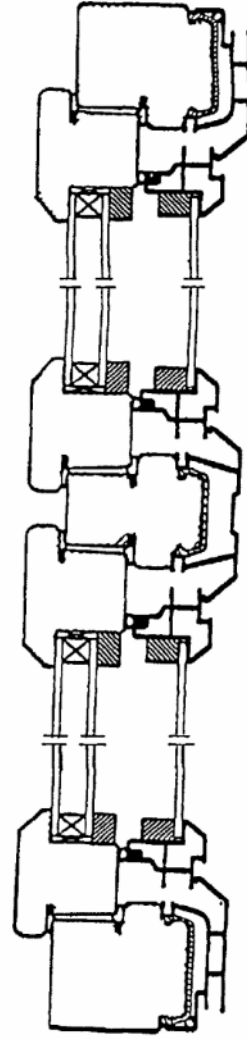

() ()

a

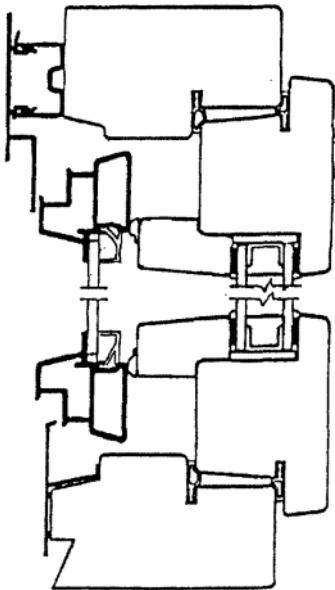

б

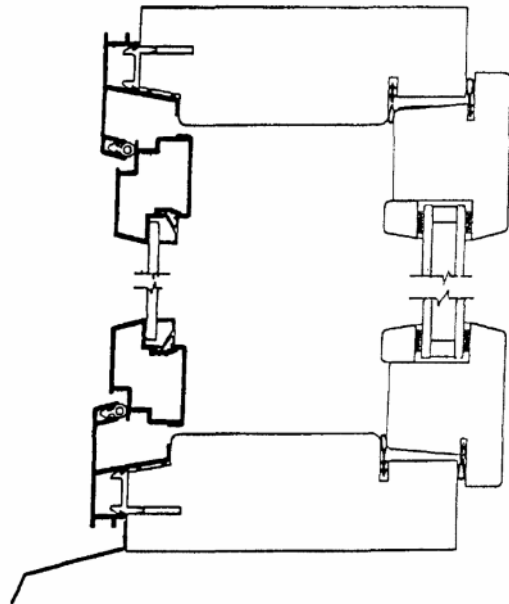

3.

()

()

a

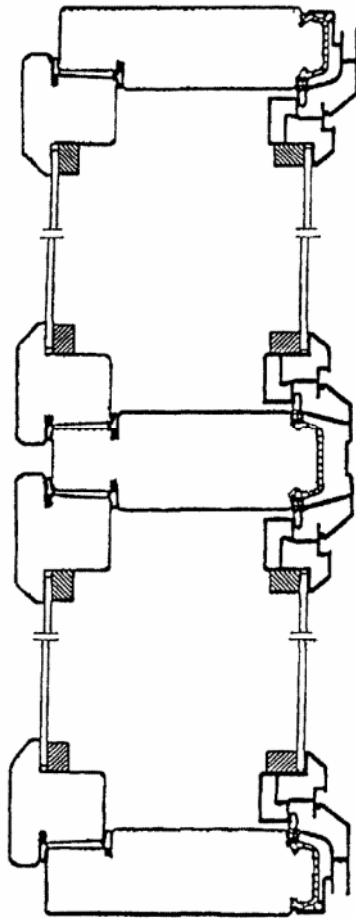

b

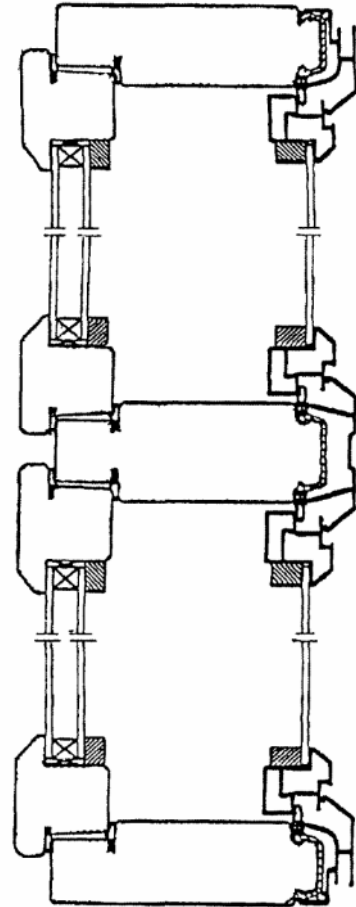

4.

() ()

5.

6.

7.

8.

5.1.9.

()

5.1.10.

()

5.1.11. ()

5.1.12. .5

()

5.1.13.

()

5.1.14.

5.1.15.

5.1.16.

5.2.

5.2.1.

1.

1

1000	+/- 1,0	-1,0	+1,0	+/- 1,5
1000	+2,0	+/- 1,0	+1,0	
2000	-1,0		-0,5	
2000	+2,0	+1,0	+1,5	
	-1,0	-2,0	-0,5	

+2,0
-1,0

2

5.2.2. 1200 3 - 1200

5.2.3. (, ,)

5.2.4. (+/- 0,4) ()

5.2.5. : +/- 3,0 - ; +/- 1,0 -

5.2.6. 1,5 1

5.2.7. (2,0) 1 (, ,)

5.2.8. () - 1,0

2

5.2.9.

()

1 .
0,5 .
1,0 1

5.2.10.

5.3.

5.3.1.

2.

2 ° / , :

4 1 + 4 1	0,38
4 1 + 4	0,50
4 1 + (4 1-8-4 1)	0,48
4 1 + (4 1-8 r- 4)	0,68
4 1 + (4 1-8 r- 4)	0,69
4 1 + (4 1-12-4 1)	0,52
4 1 + (4 1-12- 4)	0,63
4 1 + (4 1-12 r- 4)	0,68
4 1 + (4 1-12 r- 4)	0,75
4 1 + (4 1-16-4 1)	0,56
4 1 + (4 1-8-4 1-8-4 1)	0,61
4 1 + (4 1-10-4 1-10-4 1)	0,63
4 1 + (4 1-8-4 1-8- 4)	0,69
4 1 + (4 1-8 r-4 1-8 r- 4)	0,75
4 1 + (4 1-8 r-4 1-8 r- 4)	0,79
4 1 + (4 1-10-4 1-10- 4)	0,73
4 1 + (4 1-10 r-4 1-10 r- 4)	0,79
4 1 + (4 1-10 r-4 1-10 r- 4)	0,83

- , 25

- , - 28

- , - 30

(0,30 - 0,45

P = 100 , 17

3/(2) , - ,

" - " , 20000
1000 <*>

<*> , -

, 0,7.

5% . -

5% ,

1,3

0,8 2 ° / .

5.3.2.

3.

3

() ()

-	-
100	500
200	900
150	700
250	1000

<*>

-	-
250	850
300	1000

<*>

(),

5.3.3.

11

()
4.

4

	1000	. 1000 1200	1000	. 1000 1200
1300 .	700	770	980	1080
. 1300 1500 .	750	825	1050	1150
. 1500 1800 .	850	935	1190	1310
2,1 - 2,3 2	970	1070	1360	1500

30%

20%

4

5.4.

5.4.1.

) - 300 , (

45°

5.4.2.
4,0 -
26,0 -

5.4.3.
5.4.4

17005).

40

()
01.07.2003 .).

()

2/3

5.4.5.
2 - 3

8 - 10 ()

3 - 4

6 - 8
)

5.4.6.

()

120

5.4.7.

200 - 300

()

(

8486,

30972.

2695,

5.4.8.

5.4.9.

8% 14%

5.4.10.

3% (, 8% - 11%).

9.

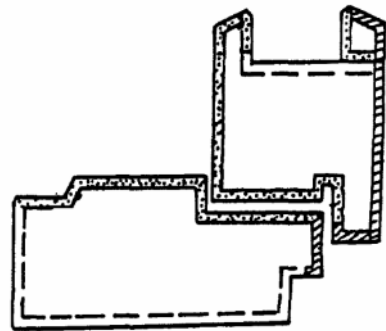
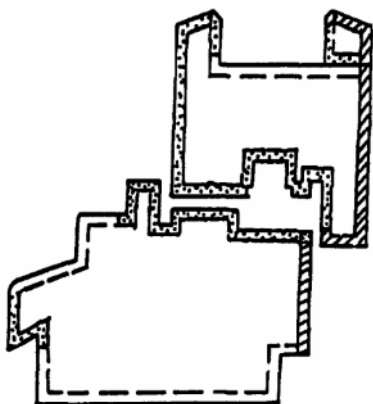
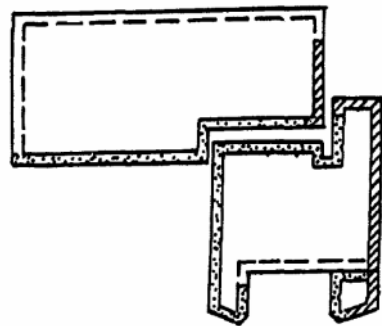
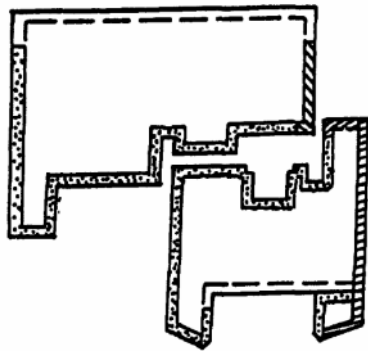

.....

9.

5.4.11.

(I), (II) (III)

5

5

2140

I II III

<*>

1.					1	
1.1.	-	10 3	15 3	20 3	25 3	25
1.2.		10 2	10 3	15 3	15 4	20
2.				1		
		2	3	3	4	5
3.		-		1		
			1	-	2	
			5		5	
4.	-					
		0,5	1,0	1,0	2,0	4,0
5.				<*>		
6.			30	/		50 /
7.						
8.						
9.						
10.			2			
		2	5	10	15	

<*>

20 / , ' , ' , 0,5 ,

1. 4 . 1 III 1 II 1 - 3

6 . 1
2.

5.4.12. (5, . 1.2), , , , , , , ,

5.4.13. 5.

5.4.14. , , , ,

5.4.15. R_m 7016 , , ,

63 - ;
80 - " " " ;
250 - " " " .

- ,) (

5.4.16. II , - III 24404. (9)

5.4.17. , , (-) , , () " ()

5.4.18. () . ()

2- 15140.

5.4.19. - ;
5 - ;
3 - 01.07.2004 .

5.4.20. , , -

5.5. 22233. ()
5.5.1. - ,) ,

5.5.2. :
, 160,0;
, 120,0;
, % 8,0.

5.5.3. () ,

5.5.4. 22233. - 9.031, 9.301, 9.303
9.032. - 20 , - 50 40 ,
- 100 40 ,

5.5.5.

9.308 -

1000

5.5.6.

9.301.

IV

9.032.

5.5.7.

()
1

300

5.6.

5.6.1.

(-).

5.6.2.

24866,

111

23166.

5.6.3.

3-6
30

()

5.6.4.

()

75 .()

5.6.5.

()

10.

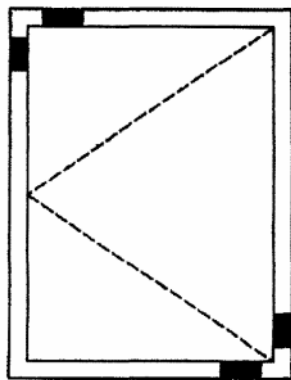

a

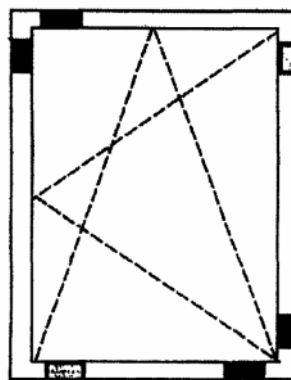

б

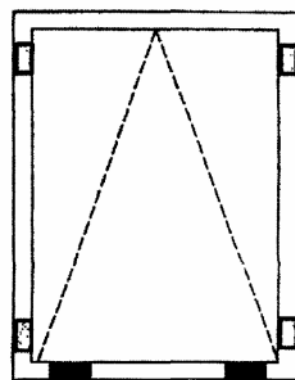

B

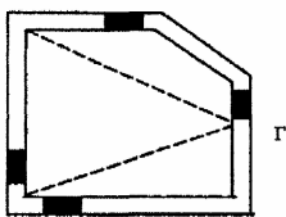

r

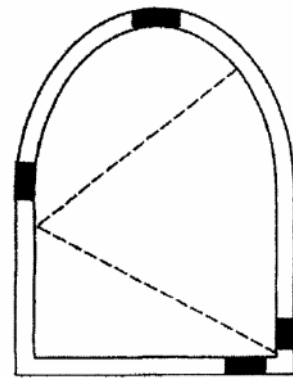

10.

()

5.6.6.

()

5.6.7.

(,) .

5.6.8.

5.6.9.

30778

) .

5.6.10.

()

5.6.11.

20

- 10

5.6.12.

538,

30777

800

5.6.13.

9.301,

9.031.

5.6.14.

500 ;

") , - 25 ;

500

500

5.6.15.

()

50 (75) ;

100 ;

(10 ;

120

5.6.16.

5.6.17.

5.6.18.

9

9.303.

5.7.

23166.

6.

6.1.

6.2.

	-	<*>			()
		I	II	III	
- - , - -	5.2.1 - 5.2.10, 5.4.4	+	+	-	I - (- 6.4), II - (- 6.5)
) (5.5.7, 5.4.13, 5.4.17	+	+	-	I - , II -
	5.4.11, 5.4.12	+	+	-	
	5.6.17	+	+	-	"
-	5.7	+	+	-	"
- -	5.6.9, 5.6.10	+	+	-	"
-	5.6.5	-	+	-	
	5.4.9	-	+	-	
-	5.4.15	-	+	-	"
	5.3.3	-	+	+	II - , III -
	5.4.18	-	+	+	"
-	5.3.2	-	-	+	
	5.4.2	-	+	+	
	5.3.1	-	-	+	"
	5.6.14 - 5.6.15	-	-	+	
	5.3.1	-	-	+	
-, -	5.3.1	-	-	+	
	5.3.1	-	-	+	"
-	5.3.3	-	-	+	"
<*> ; I - ; II - ; III -					

6.4.

6.5.

(, ,),

().

6.6.

(, , ,)

(5.4.2)

6.7.

6.8.

500

6.9.

7.

1 - 12		3	0
13 - 25	5	3	0
26 - 50	8	4	0
51 - 90	12	5	0
91 - 150	18	7	1
151 - 280	26	10	1
281 - 500	38	14	2

1,5

(.),

1,5

1,5

6.10. (), :

- ;

- ;

- ();

- (. 2);

- ;

- (),

6.11. ,

6.12. ,

7.

7.1.

7.1.1. ,

7502.

7.1.2. 26433.0 26433.1. ,

7502, 166, 427

9- 9416

() ,

7.1.3. 427,

7.1.4. 2140.

7.1.5. 16588 ()

7.1.6. 15612

7.1.7. ,

0,6 - 0,8 , 300 ,

7.1.8. 7.2.4.

7.1.9.

7.1.10.
11.

5.3.3.

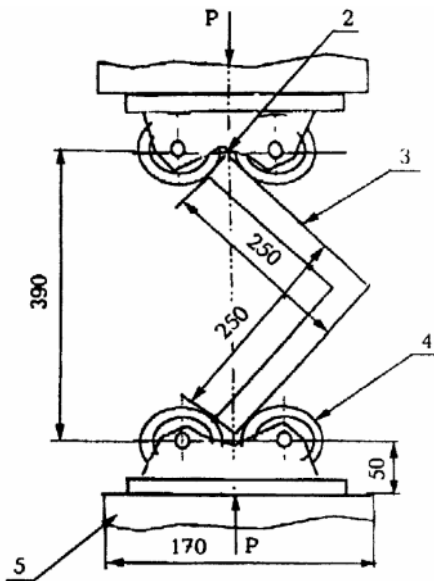
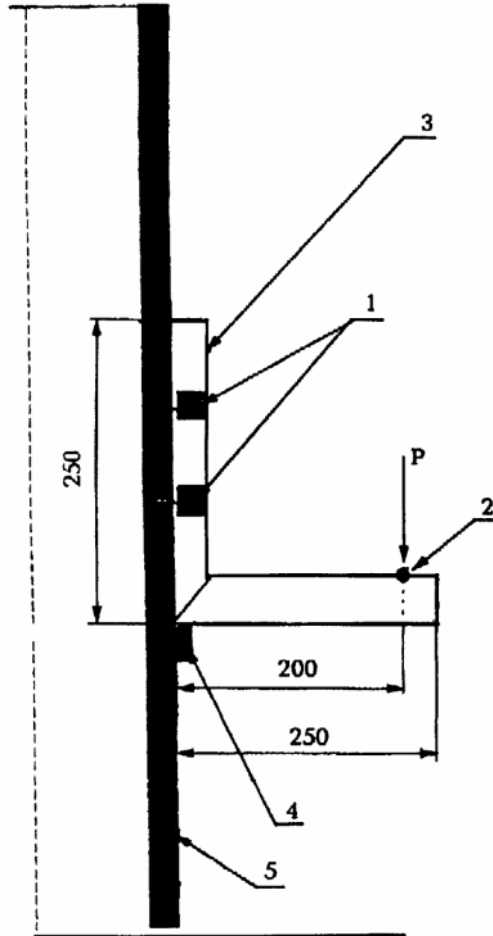

1 - ; 2 - ; 3 - ; 4 - () ; 5 - ;

11. ()

11.

).

(,

3

:

- , +/- 10 ; (,),

427;

5.3.3

+/- 2%.

(1200 +/- 25) /

1%;

()

7.1.11.
15613.1,

16 ° - 24 °

()
20%

7.1.12.

(500 +/- 5)
20

1 2
20 x 20

(600 +/- 10)

7.1.13.

7.2.
7.2.1.
15613.4.

15613.1.

10

().

20%

7.2.2.

(5.4.2.)
,

7.1.10 (

15%.

7.2.3.

17005

- 1 (20 +/- 4) ° ;

- 6 ;
- 2 (20 +/- 4) ° ;

- 1 (8 +/- 4) ° ;

- 2 (20 +/- 4) ° .

7.2.4.

15140

- ;
- ;
- ;
- 2 x 2 ;

7.2.5.

(,).
26602.1.

7.2.6.
7.2.7.
7.2.8.
7.2.9.
7.2.10.
7.2.11.

26602.3.

26602.2.

26602.4.
26602.5.
24033.

7.2.12.
7.2.13.
7.2.14.

9.401.

8.

8.1.
8.2.

- 1

23166.

9.

9.1.

9.2.

3

()

600
5 x 20 (

8)

600

1 - 2

20 - 50

20 - 50

.1, .2.

.1.

.2.

(

,

-

.4.

.3,

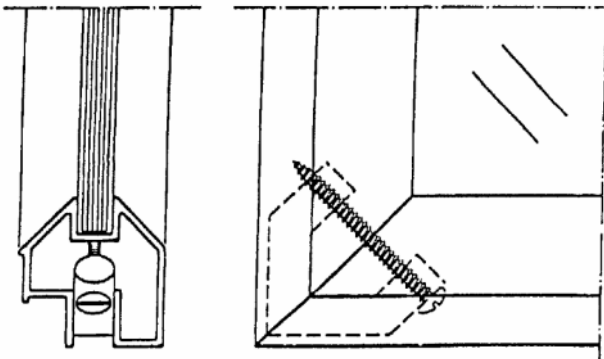
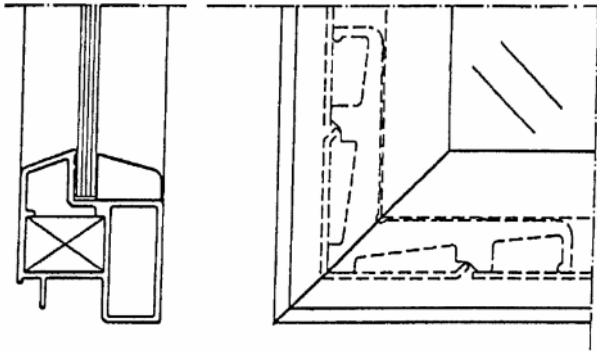
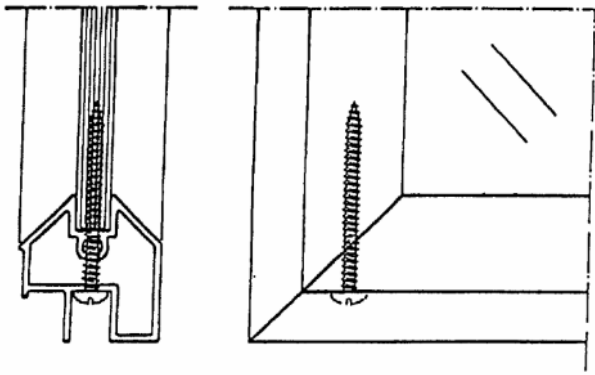

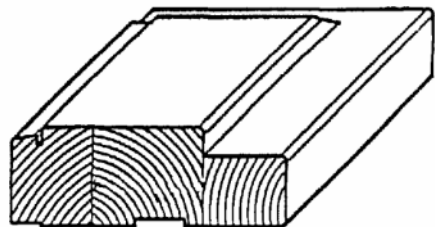
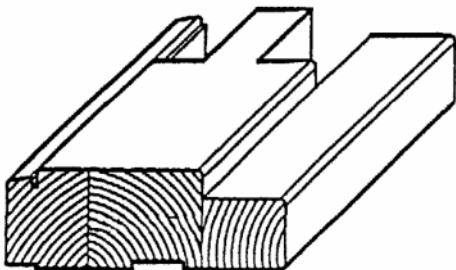
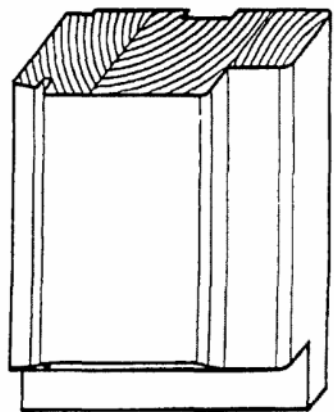
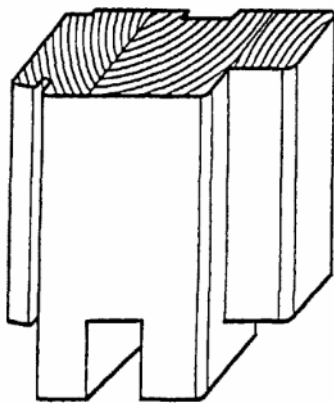
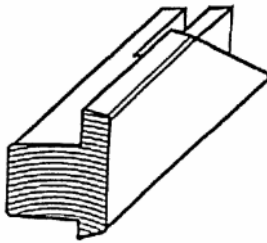
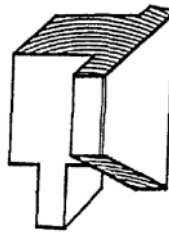
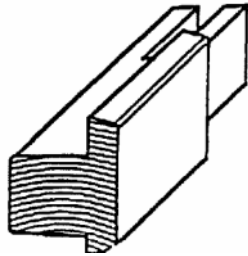
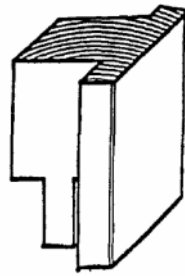

.4.

.5.

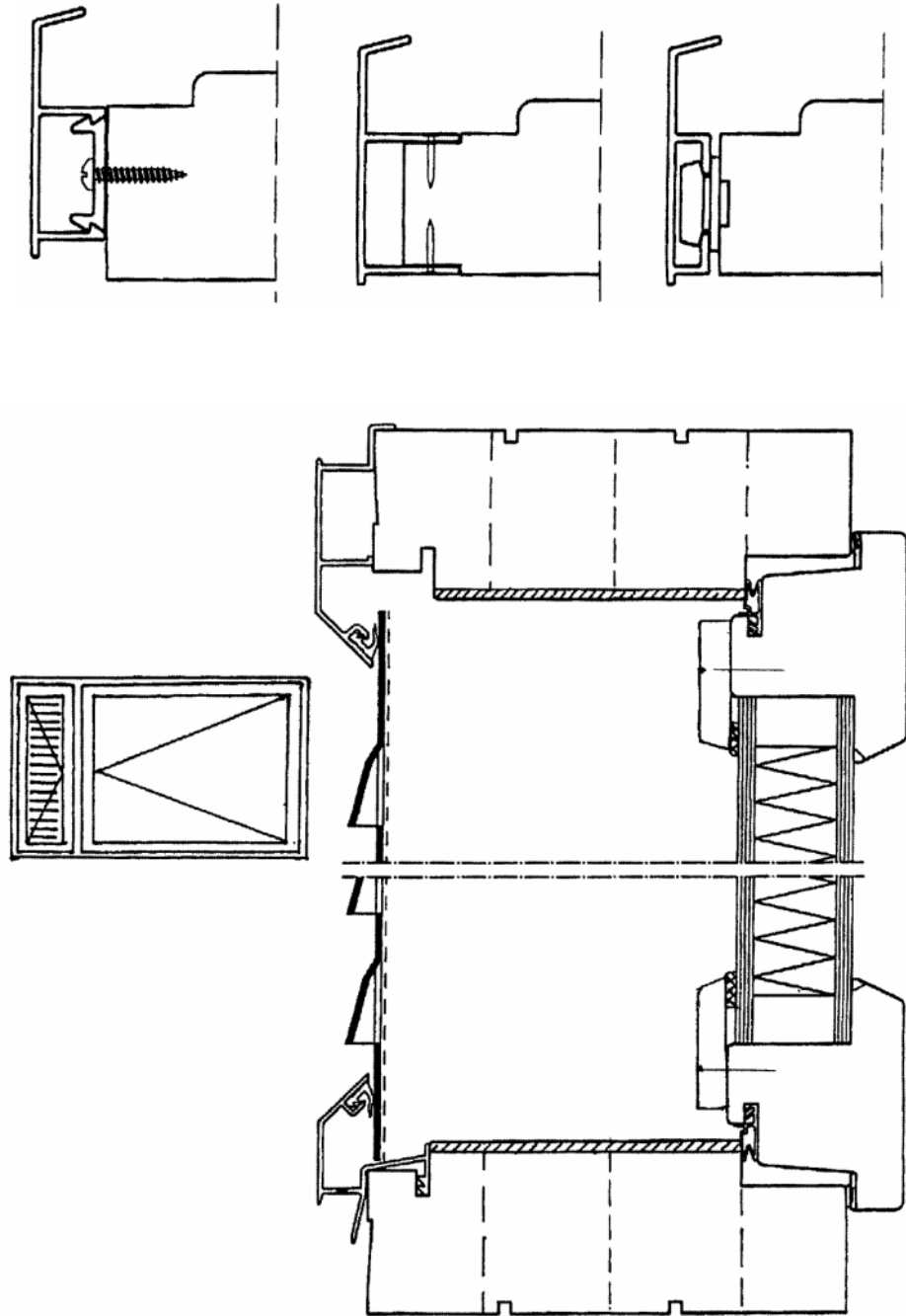

;-
(

;-)

.5

()

.1.

()

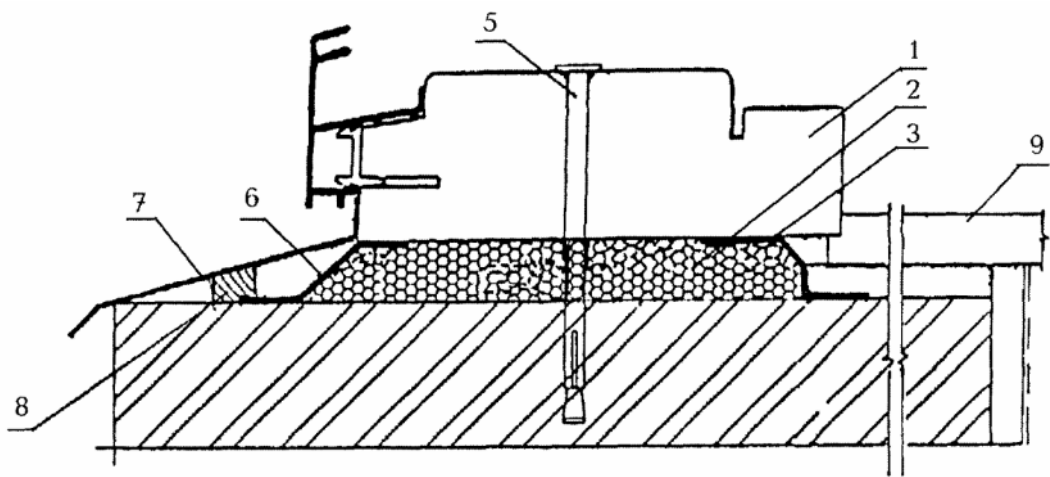
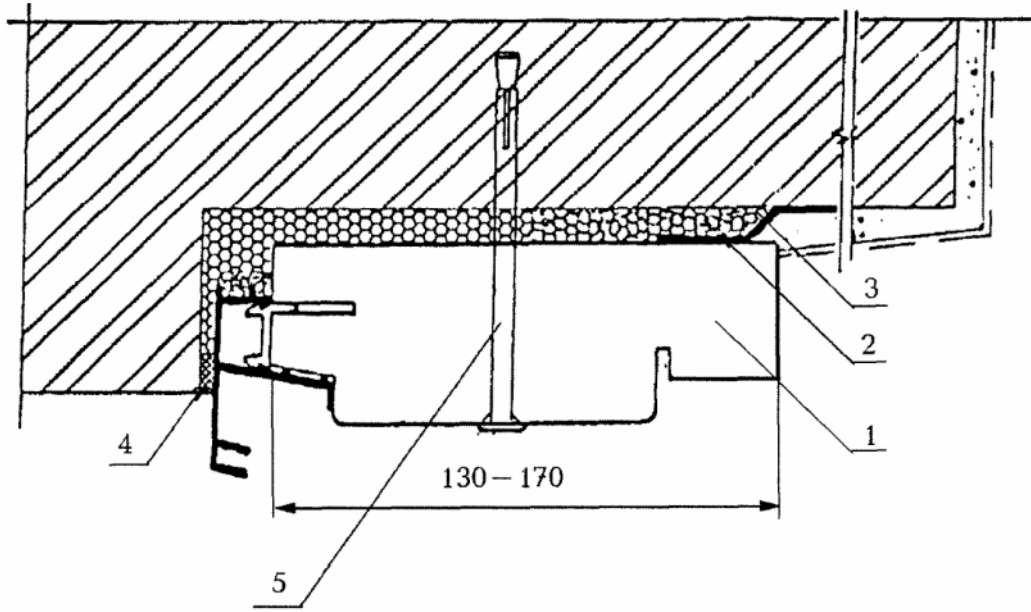

1 - ; 2 - ;
 3 - ; 4, 5 - ;
 6 - ; 7 - ;
 8 - ; 9 - ;

()

.1.

()

() ;

. . . , " " " ;
. . . , " -1" ;
. . . , "VTT building and Transport";
. . . , "Finnish association of construction product industries";
A.B. , " " " ;
. . . , " " " ;
. . . , " " " ;
. . . , " " " ;
. . . , " " " ;
B.C. , .
